

# A70Q

## SEMICONDUCTOR PROTECTION FUSES



A70Q Amp-trap® Semiconductor Protection fuses were developed for inverter applications requiring extremely low  $I^2t$ . A70Q fuses provide the most responsive protection for applications not required to sustain heavy overloads. Typically used for replacement purposes.

### Features/Benefits

- **Lowest  $I^2t$**  of any fuse in this voltage rating for best overall protection
- **700V AC, 650V DC rating** allows protection of greater variety of circuits
- **Solid fill technology** for extra reliability in performance

### Ratings

- **AC:** 35-600A  
700VAC, 100kA I.R.
- **DC:** 35-600A  
650VDC, 100kA I.R.  
L/R=10ms

### Approvals

- UL Recognized Component
- AC: Guide No. JFHR2
- DC: Tested to UL Standard 198L Parameters (35-600A)

### HIGHLIGHTS:

- Extremely Fast Acting
- Current Limiting
- Lowest  $I^2t$

### APPLICATIONS:

- Protection of inverters and other equipment requiring the best AC or DC protection in this voltage range



### Single Pole Fuse Blocks for A70Q Fuses

FUSE AMPERE RATING	FUSE BLOCK CATALOG NUMBER
35-100	P243C
125-400	P266A
450-600	P266F



\*Contact technical services for application data.

### Catalog Numbering System

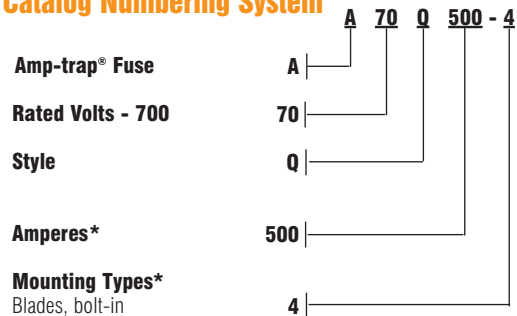

\* For ampere ratings and types not listed, consult the factory.

# A70Q

## SEMICONDUCTOR PROTECTION FUSES

### Standard Fuse Ampere Ratings, Catalog Numbers

AMPERE RATING	CATALOG NUMBER	AMPERE RATING	CATALOG NUMBER	AMPERE RATING	CATALOG NUMBER
35	A70Q35-4	100	A70Q100-4	350	A70Q350-4
40	A70Q40-4	125	A70Q125-4	400	A70Q400-4
50	A70Q50-4	150	A70Q150-4	450	A70Q450-4
60	A70Q60-4	175	A70Q175-4	500	A70Q500-4
70	A70Q70-4	200	A70Q200-4	600	A70Q600-4
80	A70Q80-4	250	A70Q250-4		
90	A70Q90-4	300	A70Q300-4		

For ampere ratings and styles not listed, call Technical Services.

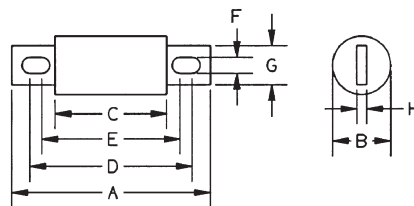

Figure 1



### Dimensions

CATALOG NUMBER	MOUNTING TYPE	DIMENSIONS - INCHES (mm)							
		A	B	C	D	E	F	G	H
A70Q35 to 60	4	4.37 (111)	1.22 (31.0)	1.96 (49.8)	3.69 (93.7)	2.91 (73.9)	.34 (8.6)	1.00 (25.4)	.19 (4.8)
A70Q70 to 100	4	4.37 (111)	1.22 (31.0)	1.96 (49.8)	3.69 (93.7)	2.91 (73.9)	.41 (10.4)	1.00 (25.4)	.19 (4.8)
A70Q125 to 200	4	5.09 (129)	1.50 (38.1)	1.96 (49.8)	4.16 (106)	2.91 (73.9)	.41 (10.4)	1.00 (25.4)	.25 (6.4)
A70Q250 to 400	4	5.09 (129)	2.00 (50.8)	1.96 (49.8)	4.00 (102)	2.94 (74.7)	.56 (14.2)	1.50 (38.1)	.25 (6.4)
A70Q450 to 600	4	7.09 (180)	2.50 (63.5)	1.96 (49.8)	5.72 (145)	3.25 (82.6)	.56 (14.2)	2.00 (50.8)	.38 (9.7)